



INSTRUCTION MANUAL

Dishwasher Model: DISHY HOME COMPACT

- ⚠ Important safety information
Please read this instruction carefully before using and keep it for future reference.

CONTENTS

Important Safety Instruction	A-01
Technical Information	A-06
Product Overview	A-06
Installation Instruction	A-07
Operation Instruction	B-01
Detergent & Rinse Aid	C-01
Loading of Dishes	C-02
Maintenance	C-03
Troubleshooting Tips	C-04
After-Sales Service	C-06

Warning

There are some important safety instructions in this manual. Please read carefully before installing and using.

This appliance is intended to be used in household and similar environments such as:

- staff kitchen areas in shops, offices and other working environments;
- farm houses;
- hotels, motels and other residential type environments;
- bed and breakfast type environments.

And the dishwasher can only be used to wash household utensils.

The dishwasher might get damaged or cause injury to users if it is wrongly installed or operated.

- The power source of dishwasher has to adopt earth line for safety purpose. This adoption will protect users from getting electric shock by possible electricity leakage.
- After installation, please make sure the connections of water and power are well connected before using.
- The installation position of drainage pipe should no exceed 40cm above the top of the appliance. Otherwise, it will cause poor drainage, electricity and water leakage.
- Knives and other utensils with sharp pointy ends must be loaded in the basket with their pointy ends faced down or placed in a horizontal position.
- This dishwasher is an automatic appliance. Do not add water manually when the appliance is working. It will cause overflow.

- Do not move or clean appliance when it is working. It might cause electricity or water leakage.
- Do not open the door during operation as the steam is hot. If it is necessary to load or unload some utensils, please push the “pause” button and wait for 10 seconds, then open the door slightly and wait for the steam to dissipate completely, before opening the door fully to load or unload your utensils.
- Please use specialized detergents. Do not use manual dishwashing liquid, washing powder, hand sanitizing soap or any other detergents not specialized for dishwashers.
- There are some cable ties on the drainage pipe and power cord. Please use rounded-tip scissors to cut the ties. Sharp end of scissors might burst the pipe and cord, causing damage and leakage.
- Do not try to use this appliance in damp place. High humidity will cause rusting on the appliance, result in possible leakage.
- The specialized detergents contain acid and alkaline. They should be placed out of reach by children.
- Utensils are hot upon washing. Please take them out only after they cool down.
- Please keep the appliance at room temperature for 8 hours after receiving the product in winter. This helps to avoid the water condensation on glass surface, and prevent potential damages caused to the appliance.
- The appliance is to be connected to the water mains using new hose sets. Old hose sets should not be reused.
- During installation, the power supply must not be excessively or dangerously bent or flattened.
- Position the appliance in the desired location. Confirm that the machine is level.
- Do not place any objects on either sides of the appliance. The openings must not be obstructed by carpets.
- Please use water not exceeding 50°C for washing.

- This appliance is not designed to be used by children or people with mental or physical disability. They should not operate the machine, unless they are given supervision or assistance by caregivers who are experienced with using the machine. Children should be supervised to ensure that they do not play with the appliance.
- The door should not be left in the open position since this could present a tripping hazard.
- Please keep children stay away from the dishwasher, especially when the door is open.
- After using the appliance, please switch off the power and water.

WARNING :

When using your dishwasher, follow basic precautions, including the following:

- Read all instructions before using the dishwasher.
- Use the dishwasher only for its intended functions.
- Use only detergents or rinse aid recommended for use in a dishwasher and keep them out of reach by children.
- When loading items for washing:
 - Place sharp object in a manner such that they are unlikely to damage the door seal;
 - Load sharp knives with the handles faced up to reduce the risk of cut-type injuries to users.
- Do not wash plastic items unless they are marked “dishwasher safe” or equivalent. For plastic items with no specific cleaning instructions, check with their manufacturers for recommendations.
- Do not touch the heating element during or immediately after the operating cycle.
- Do not operate your dishwasher unless all enclosure panels are properly in place.
- Do not tamper with controls.
- Do not abuse, sit on, or stand on the door or dish rack of the dishwasher.
- To reduce the risk of injury, do not allow children to play in or on a dishwasher.
- Under certain conditions, hydrogen gas might be produced in a hot-water system that has not been used for two weeks or more. **HYDROGEN GAS IS EXPLOSIVE.** If the hot-water system has not been used for such a period, before using the dishwasher turn on all hot-water faucets and let the water flow for several minutes. This will release any accumulated hydrogen gas. As the gas is flammable, do not smoke or use open flame during this time.



Grounding instruction

- This appliance must be grounded. In the event of a malfunction or breakdown, grounding will reduce the risk of electric shock by providing a path of least resistance to lead electric current to the ground. This appliance is equipped with a cord having an equipment-grounding conductor and a grounding plug.
- The plug must be plugged into an appropriate outlet that is installed and grounded in accordance with all local codes and ordinances.
- Improper connection of the equipment-grounding conductor can result in risk of electric shock.
- Check with a qualified electrician or service representative when you are in doubt of whether the appliance is properly grounded. Do not modify the plug come with the appliance; If it does not fit your outlet, have a proper outlet installed by a qualified electrician.
- Please do not use power strip.

Accessories

Name	Quantity	Name	Quantity
Complete appliance	1	Screws	2
Basket	1	Clamping band	1
Cutlery basket	1	Instruction manual	1
Inlet hose	1		
Drain hose	1		

Technical Data

Outline size	W550XH450XD500mm
Water pressure	0.04–1.0MPa
Control mode	Automatic
Nominal voltage	220-240V~
Frequency	50Hz
Rated power	1380W
Waterproof	IPX1
Capacity	6 Place settings
Executive standards	IEC 60335-1 IEC 60335-2-5

NOTE: Due to the continuous improvement of products, such as the technical parameters in this manual are modified without prior notice.

Product overview

Parts of Dishwasher

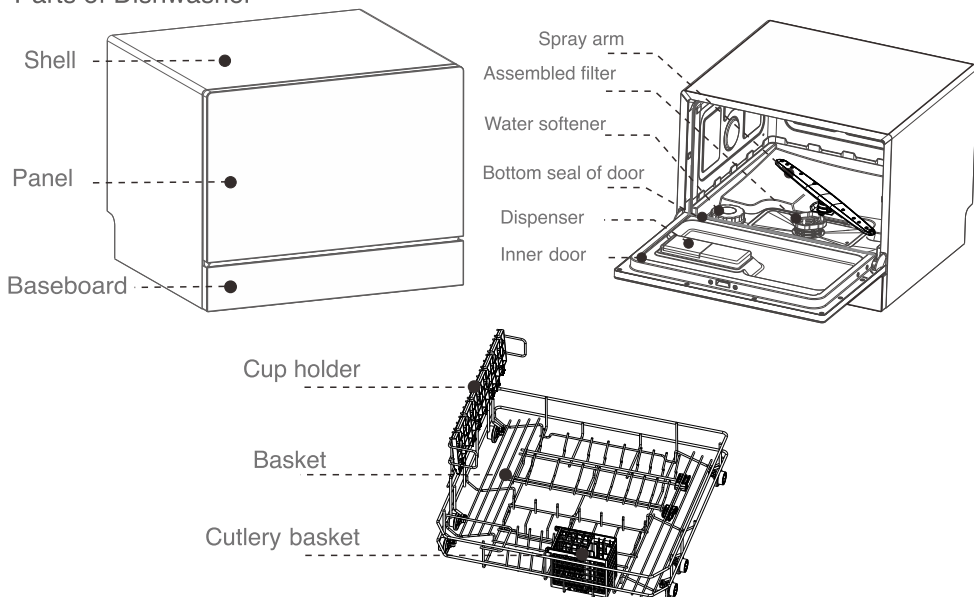

■ Installation diagram □ (unit:mm)

The direction of perforation(60*60) according to the position of the sewer

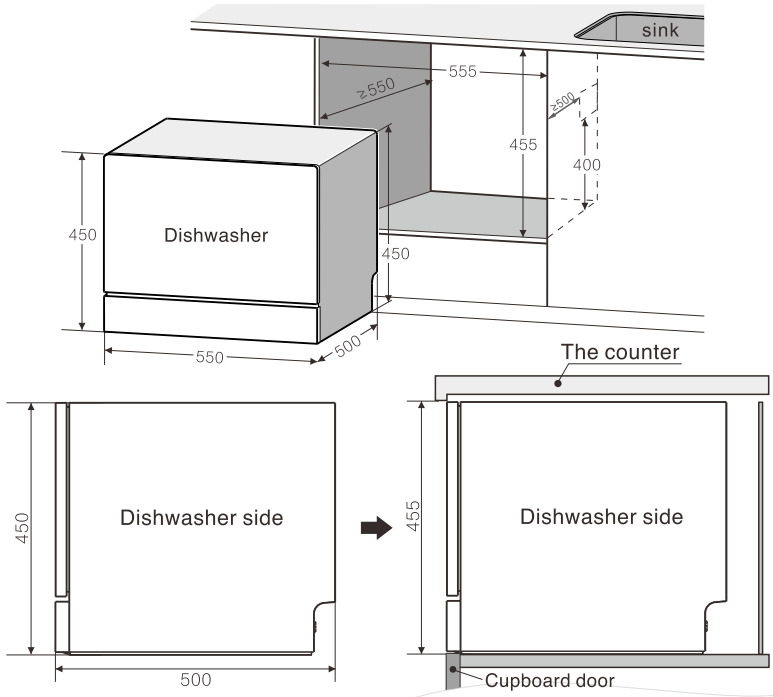

■ Table layout diagram

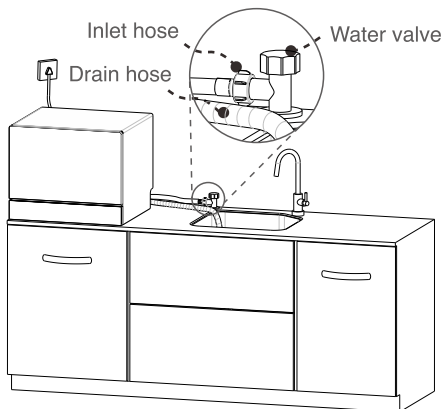

■ Inlet hose connection

Table layout diagram: Running water inlet

1. Connect the drain and drain port.
2. Connect the inlet pipe to inlet valve.

NOTE: The inlet pipe can not be recycled.

Do not use the old inlet pipe in installation.

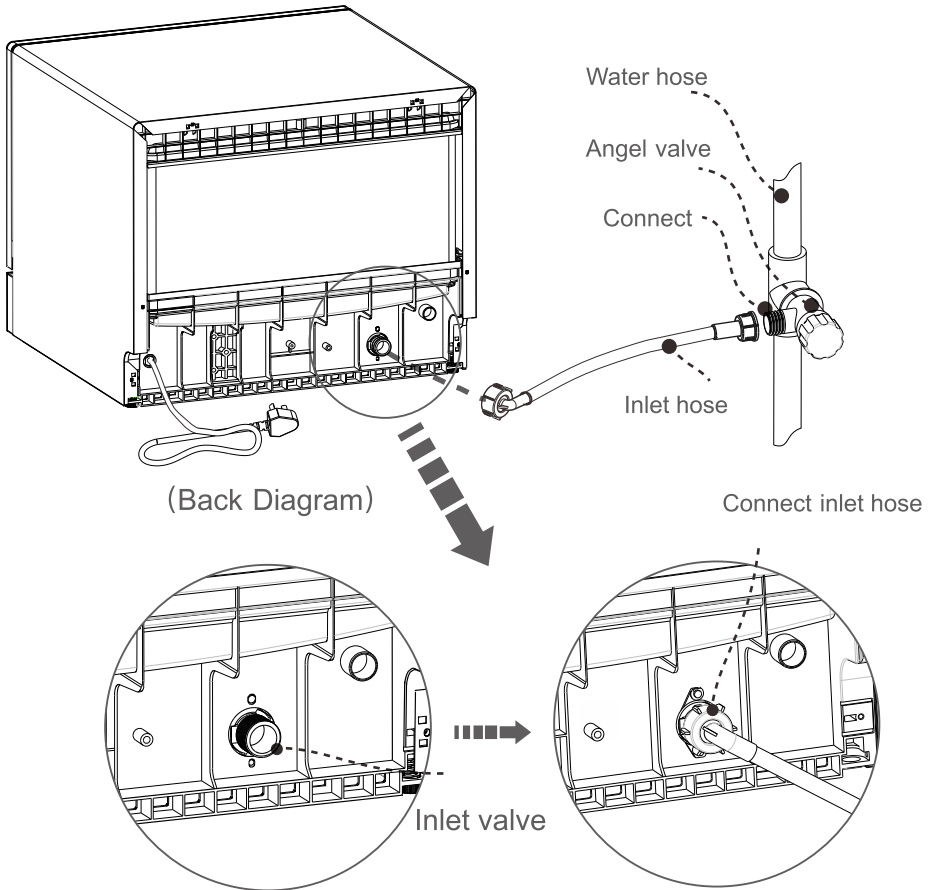

■ Drain hose connection

After the machine is fixed to the kitchen cabinet, the power cord, inlet pipe and the drain pipe should go through the reserved entrance and exit hole.

1. Connect the drain pipe to the drain port. (The height of the drain pipe hanging must not be over 40cm above the top of the machine.)
2. Connect the intake pipe to the reserved intake port and ensure that there is no drop leakage.
3. Ensure that the power outlet is well grounded and connected to the power supply.

Note:

1. The drain pipe can not be folded, if extension is needed, do not exceed 5 meters, otherwise may affect the washing effect;
2. The water inlet pipe, drain pipe and power outlet must be installed in the cabinet adjacent to the dishwasher and cannot be installed directly behind the appliance.

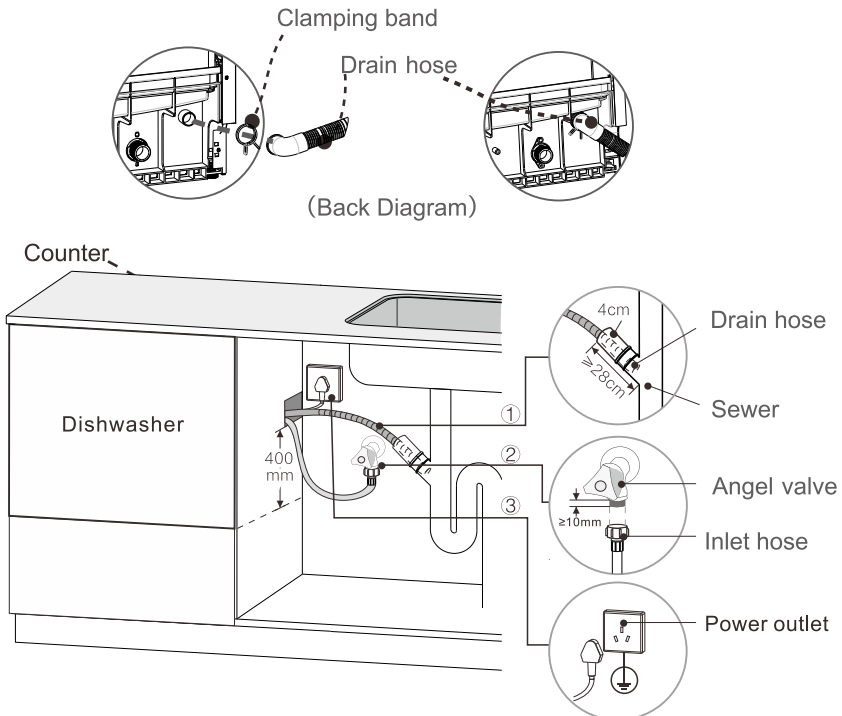

■ Secure dishwasher

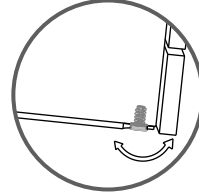
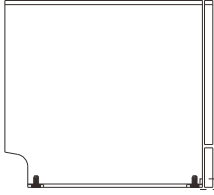

1. Ensure that the appliance is situated securely on the floor; otherwise it will cause overflow and electric leakage
2. If the dishwasher can not be placed vertically, you can adjust the adjustable foot to make it balanced.
3. If it is a built-in dishwasher, please screwed two sides of machine after it is balanced.
4. There is no need to screw the countertop, but the side safety caps must be covered.
5. Embedded-installed, fix the screw through the machine's internal hole into the cabinet board;
6. Put on the side safety caps.

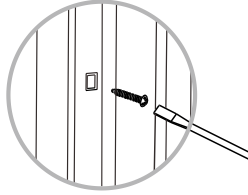

You should check these items after installation finished :

1. If the appliance is situated securely on the floor and screwed tight.
2. Ensure that the protective conductor system of the domestic supply has been correctly installed and the power is supplying.
3. If the inlet pipe and drain pipe have been connected with appliance.



TIPS:

1. After installation, please retain all documents and components for later use or for the subsequent owner.
2. When used for the first time, it is normal for released water to be yellowish.
3. Every appliance have passed the water test in factory. It is normal if you found some water left in appliance.

Operating Instruction

■ Control panel

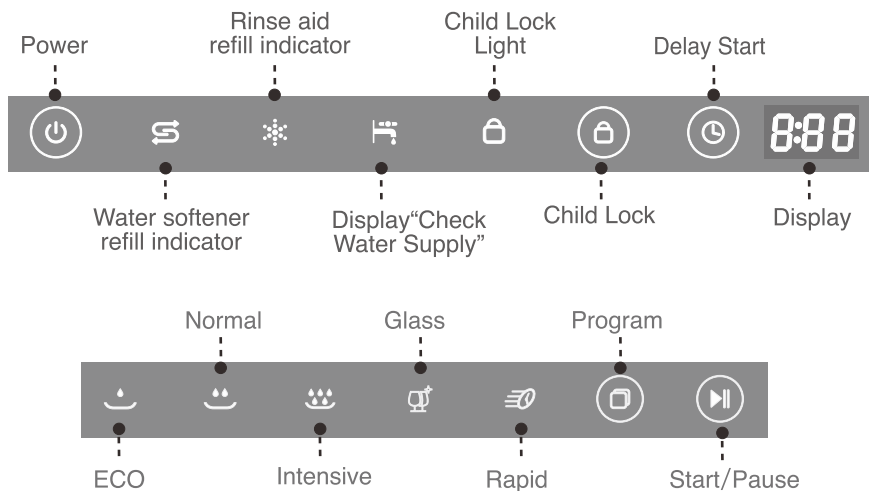

■ Operate the dishwasher

Close the door of the dishwasher and start the appliance by pressing for one second,



Change wash programme with button. Please select a suitable programme .



The indicator lamps flash, it means the dishwasher is working.



Start wash programme by pressing button.

■ Child lock

It means button lock. You can secure your appliance from being unintentionally terminated during operation (e.g. improper operation by children).

Activating the button lock: Hold down the button for 3 seconds until "🔒" is indicated on the digital display.



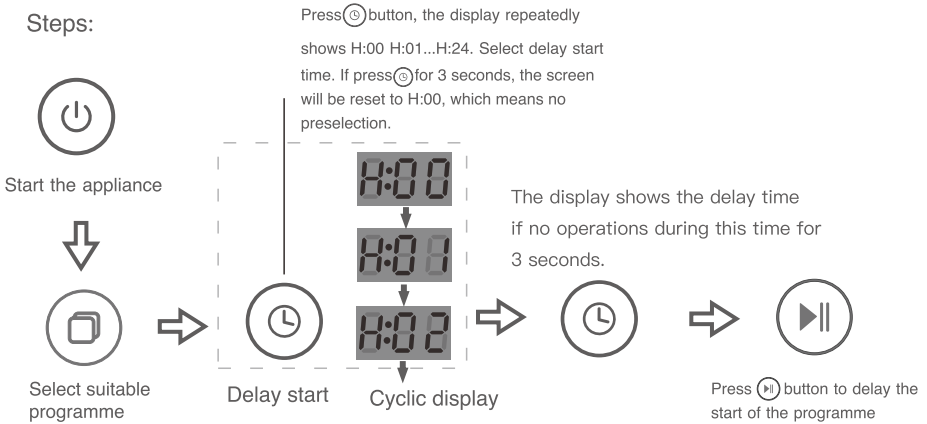

Deactivating the button lock: Hold down the button for 3 seconds until the display "🔒" goes out.

■ Delay start

You can delay the start of the programme by up to 24 hours.



■ Overview of programmes

Programme	Type of soiling	Consumption of detergent	Time cycle
		washing powder	
 Eco	Part dried, common household food remnants	14g	2:55
 Normal	Little dried, normal household food remnants (recommended)	14g	1:00
 Intensive	Very adhesive burned-in or dried-on food remnants	14g	2:55
 Glass	Slightly adhesive, temperature-sensitive plastic and glasses	14g	1:30
 Rapid	Fresh food remnants, Light and less oil.	—	0:25

*Notes: Please don't overuse the detergent. Excessive detergent will not only produce a lot of bubbles, but also affect the cleaning effect.

The actual runtime of each program is possibly different from the preset time cycle due to the water temperature, the amount of utensils, the type of soiling and the recovery of water softening.

■ Water softener

1. Water softener is used to soften water, reduce limescale and ensure utensils as bright as new. It is especially suitable for areas with higher water hardness.

Water softener setting

Making setting reference table according to the hardness of local tap water.



Water hardness (ppm)	0-90	91-200	201-300	301-400	401-500	more than 500
Hardness setting options	H1	H2	H3	H4 (Default)	H5	H6

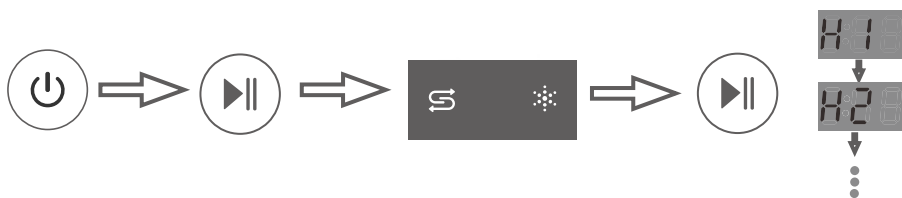

Tips: When is H1, the softener is not working, the  is lit out.



1. When the door is closed, press the power supply button.

2. Within 60 seconds after starting up, press  button for five seconds to enter setting mode.

3. Indicator "" and "" light up which indicates the appliance has been in setting mode.

4. Change and select suitable setting with  button. If user did not press  button for 5 seconds, the appliance will exit the setting mode and be in standby state. The chosen setting has been stored.

Water softener is used to soften water, reduce limescale and ensure utensils as bright as new. It is especially suitable for areas with higher water hardness.

Adding tips:

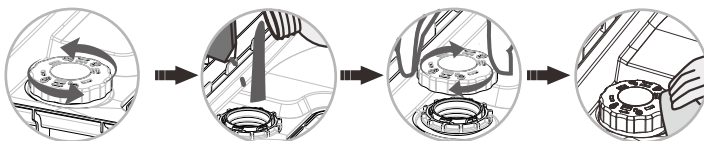

1. Turn anticlockwise and lift up water softener lid.
2. Fill it up with softener (approx. 400-500g). Please fill with some fresh water when switching on the appliance for the first time.
3. Turn the lid clockwise and fasten it tightly.

Tips:

Salt must be added before washing for the first time. It is consumable. As soon as the "Softener" light is lit on the display, softener should be topped up. Please run the "Rapid" programme after adding softener to ensure spilled softener and over run softener solution are immediately washed out. After adding plenty of special softener, "Softener" indicator won't be off immediately.

■ Detergent

Function

Special dishwasher detergent will remove oil and food residues. It is necessary every time you use the appliance. Detergent dosage depends on the amount of and type of soiling. Full load with heavy soiling , use 14g .

Adding tips

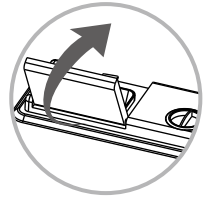
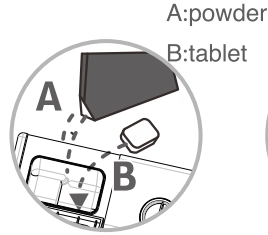
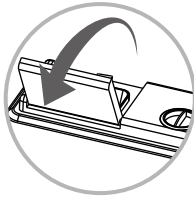
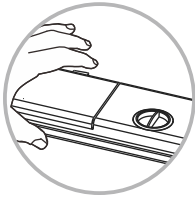

1. Press convex button on the detergent powder/tablet feeder.

2. The flap will spring open.

3. Add the required amount of detergent.

4. Close the flap.

■ Rinse aid

Function

Help to dry and shine crockery, make it as good as new.

Adding tips

Rinse aid is necessary when you use dishwasher for the first time. It is a reusable consumable. As soon as "☼" indicator is lit on display, rinse aid should be topped up.

Adjust setting based on use. Default setting is 3 . Large value means increasing dosage, and viceversa. If you feel surface is greasy, please lower setting and wash again.

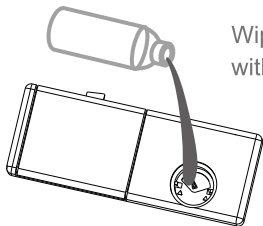

Wipe up any spills with a cloth

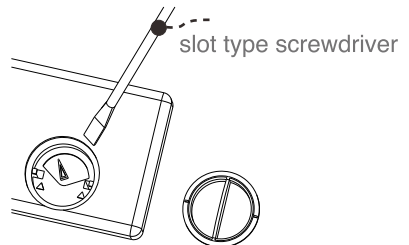

slot type screwdriver

Loading the Dishes

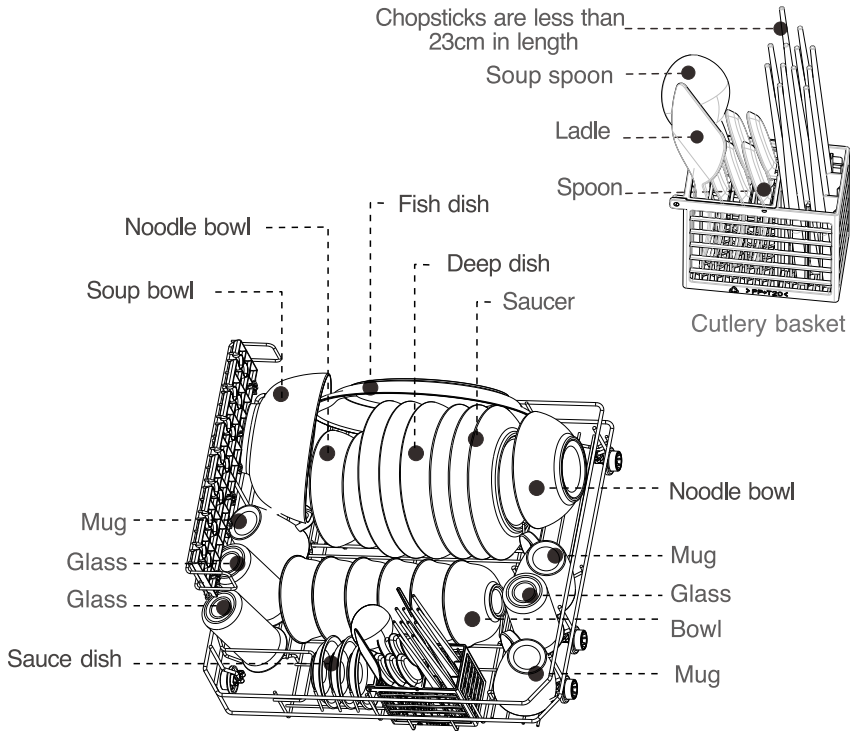

■ Utensils selection

Dishwasher-proof utensils: Ceramic tableware , Glassware and Stainless steel tableware

Utensils notes:

1. Precious metal, aluminium and colored glaze utensils may turn cloudy after being washed in a dishwasher.
2. Cutlery made of bamboo or wood: It may come loose or crack at high temperatures.
3. Plastics items: Please see manufacturer's instructions for plastics cutlery or items with plastics parts, because these items may come loose or crack at high temperature.
4. Cleaning cloth: Cleaning cloth may cause dishwasher fault.
5. Cast iron items: Cast iron items may rust after being washed in a dishwasher.

■ Tableware placement attention

1. Remove large food remnants such as bones or leaves.
2. All utensils with dirt should be face down. If they are faced up, they will leave the water on the top.

3. Utensils are secured and cannot tip over, one place for one utensil.
4. Do not let the utensils out of basket to obstruct rotation of spray arms.
5. The small size of utensils might drop out from the basket and obstruct the spray arms rotation, Please do not put these small items in the appliance.
6. When pushing basket back, do not let the sharp parts of utensils cut the seal.
7. The top coat of basket can not be scratched, or it will be rusted.
8. Place cutlery, always unsorted with the tips face down, in the cutlery basket.
9. Knives and other utensils with sharp points must be loaded in the basket with their points down or placed in a horizontal position.

TIPS:

Flick the spray arm after pushed basket, to check if the spray arm still can be rotates.

Maintenance

After appliance ran a while, there will be some residue and other things left in it. Please clean it when you see the residue and things, also clean the appliance immediately.

1. Take filtration system out .



- A** Turn the cylinder filter out (anticlockwise).

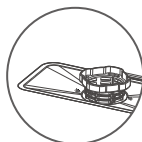

- B** Take the stainless steel filter out in the same time.

2. Flush



- A** Use flowing water to flush filter assembly. Do not use steel wool or iron brush, it will cause the filter rust.

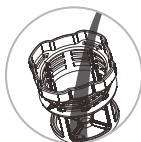

- B** Flush cylinder filter and filter net.



- C** You can put the filter back after cleaned. The cylinder filter should be assemble with clockwise until the triangle mark of filter, filter net and stainless steel in the same time.

3. Spray arms cleaning

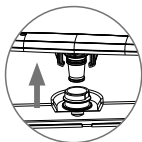

- A** Pull the main basket out of appliance, and lift the lower spray arm a little bit to loosen the clips.

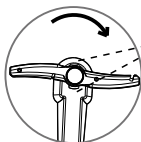

- B** Turn the top spray arm retainer clockwise.

Top spray arm retainer

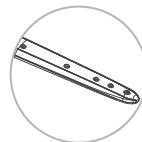

- C** Check if the spray arms are blocked. If it does, please use a thin wire to pull the blockages out or flush the hole with water.

Troubleshooting Tips

■ Error code list

Error code	Cause	Remedy
E01	Thermistor short circuit	Please contact the after-sales service department.
E02	Thermistor open circuit	Please contact the after-sales service department.
E03	The machine is not heated	1. Please make sure the utensils be placed correctly. Water will remain if it is in the plate/bow. 2. Please contact the after-sales service department.
E04	Inlet valve failure	Please contact the after-sales service department.
E05	Overflow	1. Lean the appliance about 30°to 45°to pour out the water in the bottom plate. 2. Check if the drainage pipe is placed too high. 3. Check if the pipe be tied a knot, blocked or pressed. 4. Check if the appliance is placed right. 5. Exclude above cause, try to restart the appliance again. Please contact the after-sales service department.
E06	Heating function abnormal	Please contact the after-sales service department
E10	Water inflow abnormal	1. The tap was not fully opened. 2. Small inflow and low water pressure. 3. Start-up multiple times in case of water shortage. 4. Please contact the after-sales service department.

■ Troubleshooting

Problem	Cause	Remedy
Utensils is wet	1.Out of rinse aid or it is not enough.	Add more rinse aid and turn the gear to maximum.
	2.Utensils be piled up and without lean.	Refer to utensils place rule.
	3.The washing process is still running.	Wait until process finished.
	4.Programme selected without drying.	The wash mode doesn't has drying function.
The washing powder and washing tablet have not been cleaned up	1.The holes of spray arm been blocked, the washing powder can not be flushed out.	Clean the holes of spary arms and run the quick wash mode again to clean the utensil.
	2.Put too much washing power.	Run the quick wash mode again and put moderate washing powder as instruction next time.
	3.Used low-quality washing power.	Use specialized washing powder and washing tablet with quick wash mode to wash the utensil again.
Too many drops in the inner of liner	There's no rinse aid in the container.	Add rinse aid.
Some drops in the inner of liner	It's normal and it won't impact the utensil.	
Some foam in the liner	Didn't use specialized washing powder or put too much washing powder in it.	If there's not much foam,you can open the door and let the foam dissipate; If there's too much foam,you can remove it with tools. At last,restart any programme about 3minutes. Redo this again and again until the foam disappears.
Appliance makes the noise as blowing something when is plugging. And the dispaly shows "FAN".	The air renewal system is working.	It's normal situation.

Problem	Cause	Remedy
It is hard to open the door	There are some dirt in groove, which stuck the door.	Clean the groove.
Have no reflection when pressing power button	1. If all the lights were off and no reflection when you press the button, there are possibilities that you didn't plug in the power or the power was blackout.	Please plug the power in and make sure the power have no issue.
	2. power or the power was blackout.	Clean plug the power in and make sure they are dry.
	3. All the light are on, it might be on the childproof locking mode.	Unlock the childproof lock.
	4. The time that touch power icon is too short.	Press the power icon for 1 second.
Have no reflection when pressing any button except the power botton.	1. Have not closed the door.	close the door.
	2. There are greasy dirt or water on the glass and handle.	clean the glass and handle, make sure they are dry.
	3. All the light are on, it might be on the childproof locking mode.	Unlock the childproof lock.
	4. PCB lock of door is broken.	Please contact the after sales service department.
The water light in control panel is lighting when water comes in	1. Check if the water supply have problem.	Make sure the water supply is turned on.
	2. The flowmeter is broken.	Please contact the after sales service department.
	3. The filling valve is broken.	Please contact the after sales service department.
Have crashing noise when it is working	Place the utensil in improper way ,some utensils is obstructing the spray arms; or some utensils are crashing each other.	Unload the dishwasher and replace the utensils in proper way.
There utensil was not cleaned up	1. utensils be piled up and without lean.	Refer to utensils place rule.
	2. Do not chose the right programme of washing.	Please chose the right programme of washing.
	3. Do not use pecialized washing powder or put too little of washing power.	Use specialized washing powder and put enough of it before washing.
	4. Do not install the filter in right position and the food remnants get in it.	Re-install the filter in correct position.
	5. The spray arms were blocked.	Clean the inner part of spray arms.
	6. The spray arms are stuck.	Check if the spray arm is stuck by the utensil.
	7. Some food remnants are sticking on the utensil	Soak the utensil for a while before washing.
	8. Black out when the appliance is working.	Restart the washing programme.
	9. Some food remnants are too hard to wash	Suggest wash utensil with steel wool before put it in appliance to wash.
A lot of water were left in appliance when is not working	1. The position of drainage pipe is too high.	Refer to drainage pipe installation.
	2. The drainage pipe is tied, blocked or pressed by something heavy.	Untie the pipe and remove the heavy thing.
	3. Drainage pump is broken.	Please contact the after-sales service department.
	4. The filling valve is broken.	Please contact the after-sales service department.

If the solutions above can not fix the problems, please stop to use appliance immediately and cut off the power and water supply. Please contact the after-sales department.

1 Warranty requirements

*Free warranty within 12 months from date of delivery. Registration on dishyhome.sg

*The following conditions do not fall within the scope of free maintenance during the warranty period:

- 1、 Damage caused by improper use and maintenance of users;
- 2、 Damage caused by irresistible natural disasters. (typhoons, snow disasters, hail, earthquakes, debris flows, etc..)
- 3、 Repair by an unqualified third party.



The presence of this logo on the product means that the disposal of the device is governed by directive 2012/19/EU dated July 4, 2012 on waste electrical and electronic equipment(WEEE). Any hazardous substance contained in electrical or electronic equipment can have a potential impact on the environment and health during its recycling. Consequently, at the end of the useful life of the device, it must not be disposed of with unsorted municipal waste. Your role as an end consumer is

essential in terms of reuse, recycling and obtaining other types of value creation from this product. You have the choice of different collection and exchange systems organized by local authorities (recycling centers) and distributors. It is your duty to make use of these possibilities.

You may also contact Dishy Home for disposal service.

STATEMENT :

With the innovation and improvement of product technology, the product specifications of the same model as this product may be changed, and the change part will be notified without further notice.

The pictures of the products in the instruction are all borrowed from the appearance of the dishwasher, and the pictures are only used as an example. The actual appearance should be based on the purchased products.

As a result of product improvement, the execution standards of product manufacturing may be changed, and the revised standards of execution will be changed.

There is no retroactive effect on the sold product.



Address: Block 20 Ang Mo Kio Industrial Park 2A,
#03-05, Singapore 567761

Website: www.dishyhome.sg

Phone: +65 8022 0166

